

THIS COPY IS PROVIDED ON A RESTRICTED BASIS AND IS NOT TO BE USED IN ANY WAY DETRIMENTAL TO THE INTERESTS OF PANDUIT CORP.

- NOTES:
- VISIT OUR ON-LINE CATALOG AT WWW.PANDUIT.COM FOR A LIST OF CURRENT PARTS APPLICABLE FOR USE WITH THIS PRODUCT.
 - DIMENSIONS IN [] ARE METRIC.
 - ALL MATERIALS AND COMPONENTS USED MEET THE MATERIAL RESTRICTIONS OF RoHS (EUROPEAN DIRECTIVE 2011/65/EU ON THE RESTRICTION OF HAZARDOUS SUBSTANCES) AS PROPOSED BY THE RoHS TECHNICAL ADAPTATION COMMITTEE.
 - MATERIAL:
ENCLOSURE - POLYAMIDE 6.6
SEAL - TPU/EPDM
 - PROTECTION CLASS:
NEMA 1,12
IP 65
 - TEMPERATURE RANGE: -22 - 158 °F
 - FLAMMABILITY: HB
 - UV RESISTANT
 - RoHS COMPLIANT
 - COMPLIANCE: cURus
 - FOR SNAPPING INTO 0.06" - 0.08" THICK PLATES
 - WEIGHT: SEE TABLE

PART NUMBER	A	B	INSTALLATION HEIGHT in. (mm)	NUMBER OF OPENINGS		a	b	c	d	e	PART WEIGHT	PKG QTY
	in. (mm)	in. (mm)		TOTAL	NUMBER X DIA.	in. (mm)	in. (mm)	in. (mm)	in. (mm)	in. (mm)	lbs. (g)	
CESU2-E10	2.32 (59)	5.79 (147)	0.59 (15)	10	2 x 0.12 - 0.26 (2 x 3 - 6.5)	4.41 (112)	1.42 (36)	2.56 (65)	0.63 (16)	0.22 (5.5)	0.198 (90)	1
					1 x 0.2 - 0.36 (1 x 5 - 9.2)							
					5 x 0.35 - 0.55 (5 x 9 - 14)							
					2 x 0.55 - 0.79 (2 x 14 - 20)							
CESU2-E11	2.32 (59)	5.79 (147)	0.59 (15)	11	4 x 0.12 - 0.26 (4 x 3 - 6.5)	4.41 (112)	1.42 (36)	2.56 (65)	0.63 (16)	0.22 (5.5)	0.207 (94)	1
					4 x 0.2 - 0.36 (4 x 5 - 9.2)							
					3 x 0.55 - 0.79 (3 x 14 - 20)							
CESU2-E12	2.32 (59)	5.79 (147)	0.59 (15)	12	12 x 0.31 - 0.47 (12 x 8 - 12)	4.41 (112)	1.42 (36)	2.56 (65)	0.63 (16)	0.22 (5.5)	0.207 (94)	1
CESU2-E13	2.32 (59)	5.79 (147)	0.59 (15)	13	2 x 0.12 - 0.22 (2 x 3 - 5.5)	4.41 (112)	1.42 (36)	2.56 (65)	0.63 (16)	0.22 (5.5)	0.205 (93)	1
					6 x 0.16 - 0.32 (6 x 4.1 - 8.1)							
					4 x 0.35 - 0.55 (4 x 9 - 14)							
					1 x 0.55 - 0.79 (1 x 14 - 20)							
CESU2-E14	2.32 (59)	5.79 (147)	0.59 (15)	14	6 x 0.12 - 0.26 (6 x 3 - 6.5)	4.41 (112)	1.42 (36)	2.56 (65)	0.63 (16)	0.22 (5.5)	0.207 (94)	1
					4 x 0.2 - 0.36 (4 x 5 - 9.2)							
					4 x 0.38 - 0.63 (4 x 9.6 - 15.9)							
CESU2-E17	2.32 (59)	5.79 (147)	0.59 (15)	17	17 x 0.2 - 0.36 (17 x 5 - 9.2)	4.41 (112)	1.42 (36)	2.56 (65)	0.63 (16)	0.22 (5.5)	0.209 (95)	1
CESU2-E17A	2.32 (59)	5.79 (147)	0.59 (15)	17	11 x 0.12 - 0.26 (11 x 3 - 6.5)	4.41 (112)	1.42 (36)	2.56 (65)	0.63 (16)	0.22 (5.5)	0.212 (96)	1
					1 x 0.16 - 0.32 (1 x 4.1 - 8.1)							
					5 x 0.31 - 0.49 (5 x 8 - 12.5)							
CESU2-E22	2.32 (59)	5.79 (147)	0.59 (15)	22	16 x 0.12 - 0.26 (16 x 3 - 6.5)	4.41 (112)	1.42 (36)	2.56 (65)	0.63 (16)	0.22 (5.5)	0.209 (95)	1
					4 x 0.2 - 0.36 (4 x 5 - 9.2)							
					2 x 0.31 - 0.49 (2 x 8 - 12.5)							
CESU2-E23	2.32 (59)	5.79 (147)	0.59 (15)	23	23 x 0.16 - 0.32 (23 x 4.1 - 8.1)	4.41 (112)	1.42 (36)	2.56 (65)	0.63 (16)	0.22 (5.5)	0.207 (94)	1
CESU2-E29	2.32 (59)	5.79 (147)	0.59 (15)	29	29 x 0.12 - 0.26 (29 x 3 - 6.5)	4.41 (112)	1.42 (36)	2.56 (65)	0.63 (16)	0.22 (5.5)	0.212 (96)	1

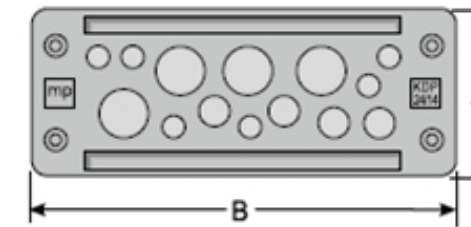

PART

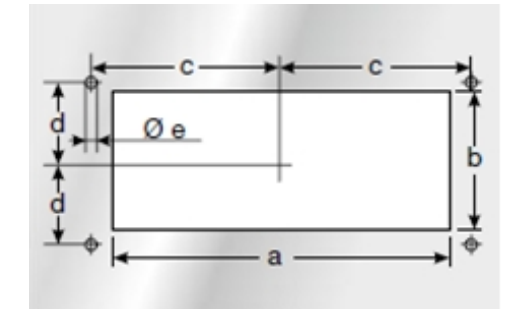

CUTOUT



PART NUMBER		SEE TABLE	
TITLE			
CESU2 Control Drawing			
CUSTOMER DRAWING			
ITEM REVISION NAME		00872EBI/00	
DATASET FILE NAME		00872EBI_DC/00A	
		THIRD ANGLE PROJECTION	
MATERIAL		SEE NOTE 2	
DRAWING NUMBER		00872EBI - DC	
DRAWN BY	DATE	CHK	SCALE
SERH	9/13/2022	SERH	1:1
SHEET 1 OF 1			B

00A	9/13/2022	SERH	MDS	JADE	INITIAL RELEASE	124032/00
REV	DATE	BY	CHK	APR	DESCRIPTION	ECN

B

B

←

→

A

A

B-SIZE CUSTOMER